

# FUTEK MODEL LSM250 (L2331)

# PARALLELOGRAM LOAD CELL WITH OVERLOAD PROTECTION (OEM TYPE)

Drawing Number: F11039

INCH [mm] R.O.= Rated Output

WIRING CODE (WC2)

+Excitation	-Excitation	+Signal	-Signal
GREEN	BLACK	WHITE	RED

COLOR CODE FOR THIS SENSOR IS NOT FUTEK STANDARD

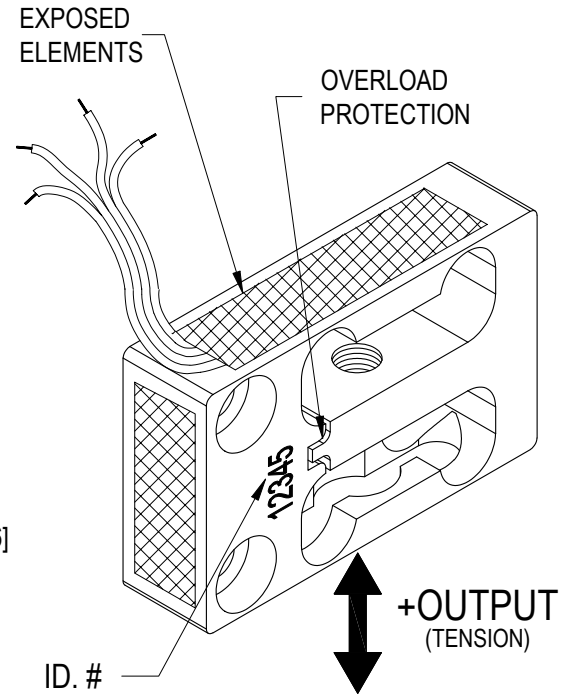
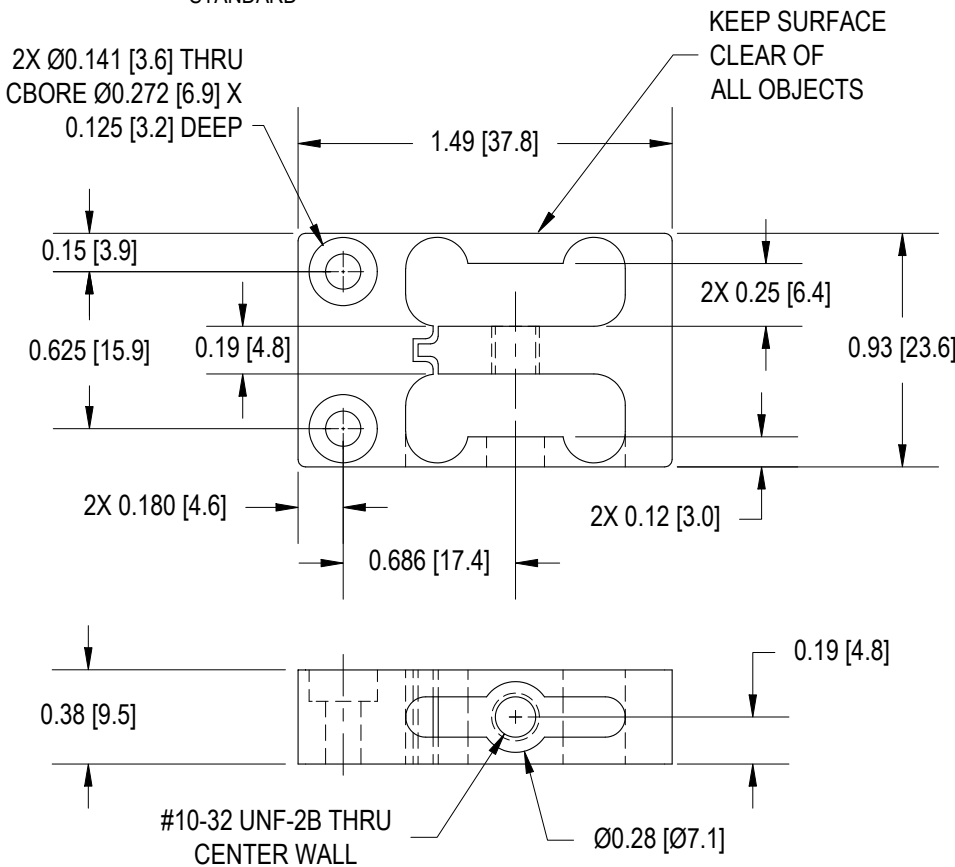

**NOTE:**

**\*\* HANDLE WITH CARE, ALWAYS MONITOR OUTPUT DURING INSTALLATION. \*\***

**SPECIFICATIONS:**

<b>RATED OUTPUT</b>	2 mV/V nom.
<b>SAFE OVERLOAD</b>	50 lb
<b>ZERO BALANCE</b>	±3% of R.O.
<b>EXCITATION (VDC OR VAC)</b>	18 MAX
<b>BRIDGE RESISTANCE</b>	1000 Ω nom.
<b>NONLINEARITY</b>	±0.05% of R.O.
<b>HYSTERESIS</b>	±0.05% of R.O.
<b>NONREPEATABILITY</b>	±0.05% of R.O.
<b>CREEP</b>	±0.05% of LOAD.
<b>TEMP. SHIFT ZERO</b>	±0.005% of R.O./°F [0.01% of R.O./°C]
<b>TEMP. SHIFT SPAN</b>	±0.005% of LOAD/°F [0.01% of LOAD/°C]
<b>COMPENSATED TEMP.</b>	60 to 160 °F [15 to 72 °C]
<b>OPERATING TEMP.</b>	-60 to 200 °F [-50 to 93 °C]
<b>WEIGHT</b>	1 oz [28 g]
<b>MATERIAL</b>	ALUMINUM
<b>NOM. DEFLECTION</b>	0.004 [0.10]
<b>CABLE: #29 AWG, 4 Conductor, Spiral Teflon Cable 6 [0.3 m] Long</b>	
<b>ACCESSORIES AND RELATED INSTRUMENTS AVAILABLE</b>	
<b>CALIBRATION (STD)</b>	2 pt. TENSION; 150KΩ SHUNT CAL. VALUE
<b>CALIBRATION (AVAILABLE)</b>	2 pt. COMPRESSION
<b>CALIBRATION TEST EXCITATION</b>	10 VDC

Stock #	CAPACITY	
	lb	N
FSH00011	1/4	1.1
FSH00012	1/2	2.2
FSH00013	1	4.5

FOR HIGHER CAPACITIES REFER TO MODEL LSM300 (L2330)